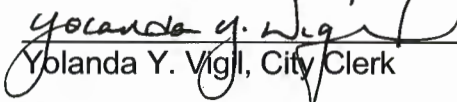

City of Santa Fe, New Mexico

memo

DATE: March 23, 2016
TO: Mayor Gonzales & City Councilors
VIA: 
Brian K. Snyder, City Manager

FROM: 
Yolanda Y. Vigil, City Clerk

ITEM & ISSUE

Request for a Restaurant Liquor License (beer and wine with on-premise consumption only).

BACKGROUND AND SUMMARY

Paperbag, LLC has requested the following:

- 1) Pursuant to §60-6B-10 NMSA 1978, a request for a waiver of the 300 foot location restriction to allow the sale of beer and wine at Dr. Field Goods Kitchen, Butcher Shop & Bakery, 2860 Cerrillos Road, #B5, which is within 300 feet of Santa Fe Christian Fellowship Church, 2860 Cerrillos Road, Suite #C5;
- 2) If the waiver of the 300 foot location restriction is granted, a request from Paperbag, LLC for a Restaurant Liquor License (beer and wine with on-premise consumption only) to be located at Dr. Field Goods Kitchen, Butcher Shop & Bakery, 2860 Cerrillos Road, #B5.

Attached is a letter of no objection from Pastor John S. Maiolo, Santa Fe Christian Fellowship Church.

Included in your packet are staff reports regarding litter, noise and traffic. Staff does not anticipate a substantial change in litter and noise or any unacceptable traffic impacts due to the approval of this request.

Staff is recommending that it be noted that Dr. Field Goods Kitchen, Butcher Shop & Bakery is required to comply with all of the city's ordinances as a condition of doing business in the city.

ACTION REQUESTED

I request that the Governing Body indicate its decision of the waiver of the 300 foot location restriction and if the waiver is granted, consideration of the issuance of a Restaurant Liquor License (beer and wine with on-premise consumption only) to be located at Dr. Field Goods Kitchen, Butcher Shop & Bakery, 2860 Cerrillos Road, #B5.

Attachments: Alcohol & Gaming Division Application
 Letter/Santa Fe Christian Fellowship Church
 Notice of Public Hearing
 Staff Reports
 §60-6B-10 NMSA 1978



RESTAURANT LIQUOR LICENSE APPLICATION

Application fee - \$200.00 Fees are non-refundable.

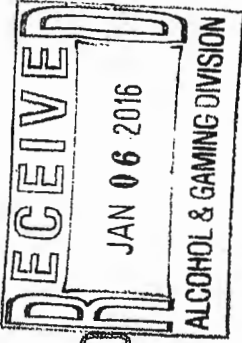

AGD USE ONLY - APPLICATION # 987765 LOD

Application is for: New License / Change of Stock among existing members only / Change of Officers (no ownership interest)

Applicant is: Individual / Corporation / Partnership (General or Limited) / Limited Liability Company

NAME OF APPLICANT (company or individual) Paperbag LLC

ADDRESS (including city, state, zip) 4 Cosmos Circle, Santa Fe, NM 87506

TELEPHONE NUMBER OWNER 505-670-6101

EMAIL josh@drfieldgoods.com

D/B/A name to be used: Dr. Field Goods Kitchen and Butcher Shop + Bakery Phone number for licensed premises: TBD

Physical location where license is to be used: 2860 Cerrillos Road # B5 (A1 Annex), Santa Fe, NM 87507

(Include street number / highway number / state road, city and county, state, and zip code)

Mailing address: Dr. Field Goods Kitchen and Butcher Shop, 4 Cosmos Circle

Are alcoholic beverages currently being dispensed at the proposed location? Yes No If yes, give license number and type _____

I, (print name) Joshua Paul Gerwin, as (title) Owner/Manager being first duly sworn upon oath deposes and says: that he/she is the applicant or is authorized by the applicant to make this application; that he/she has read the same; knows the contents therein contained are true. Applicant(s) agree(s) that if any statements or representations herein are found to be false, the director may refuse to issue or renew the license or may cause the license to be revoked at any time.

You must sign and date this form in the presence of a notary public.

Signature of Applicant Josh Gerwin Date 1/6/15

SUBSCRIBED AND SWORN TO before me this 6th day of January, 2016 by Josh Gerwin

Notary Public Shirley Rodriguez My Commission Expires April 25, 2017



Local Governing Body of: _____ (City or County). Hearing held on _____

Check one: Approved Disapproved City/County Official _____

For Alcohol and Gaming Division Use Only

Approved _____ Disapproved _____ Director Approval _____

Date _____

(Signature & Title)



PREMISES LOCATION, OWNERSHIP, AND DESCRIPTION
SS-60-6B-10

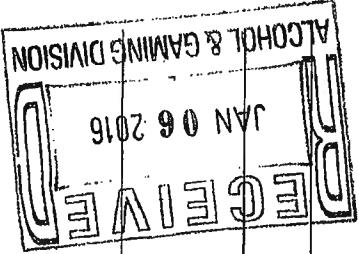

1. The land and building which is proposed to be the licensed premises is (check one):

Owned by Applicant _____ Leased by Applicant (attach copy of deed or lease) Other (provide details) _____

2. If the land and building are not owned by Applicant, indicate the following:

A. Owner(s) Gardenswartz Plaza Associates Limited Partnership

B. Date and term of lease August 1, 2013 to September 30, 2017 with 2 5 year options to extend

3. Premises location is zoned (example C-1) C-2

If the premises is zoned, attach zoning statement from local government giving location address and type of zone, stating whether alcoholic beverages are allowed at proposed location. If there is no zoning, attach confirmation from local government indicating there is no zoning.

4. Distance from nearest church *(Property line of church to licensed premises—shortest distance).

Miles/feet 131 Feet Name of church Santa Fe Christian Fellowship Address/location of church 2860 cerrillos rd

5. Distance from nearest school *(Property line of school to licensed premises—shortest distance).

Miles/feet 08 Name of school Fares Navat Ekunday Address/location of school 2655 seringgo rd 87505

6. Distance from military installation *(Property line of military installation to licensed premises—shortest distance.)

Miles 60 Name of Military Installation, circle one: Kirtland Air Force Base (Albuquerque) White Sands Missile Range (Las Cruces), Holloman Air Force Base (Alamogordo), Cannon Air Force Base (Clovis).

7. Attach, on a separate sheet, the detailed floor plan for each level (floor) where alcoholic beverages will be sold or consumed. Show exterior walls, doors, and interior walls. This will be the licensed premises. The floor plan should be no larger than 8 1/2 x 11 inches, and must include the total square footage of premises.

*If the distance is beyond 300 feet, but less than 400 feet, a registered engineer or licensed surveyor must complete a Survey Certificate showing the exact distance.

8. Type of Operation:

Lounge _____ Restaurant Package Grocery _____ Racetrack _____ Hotel _____ Other (specify) Retail food Sales

Handicap Locker Location

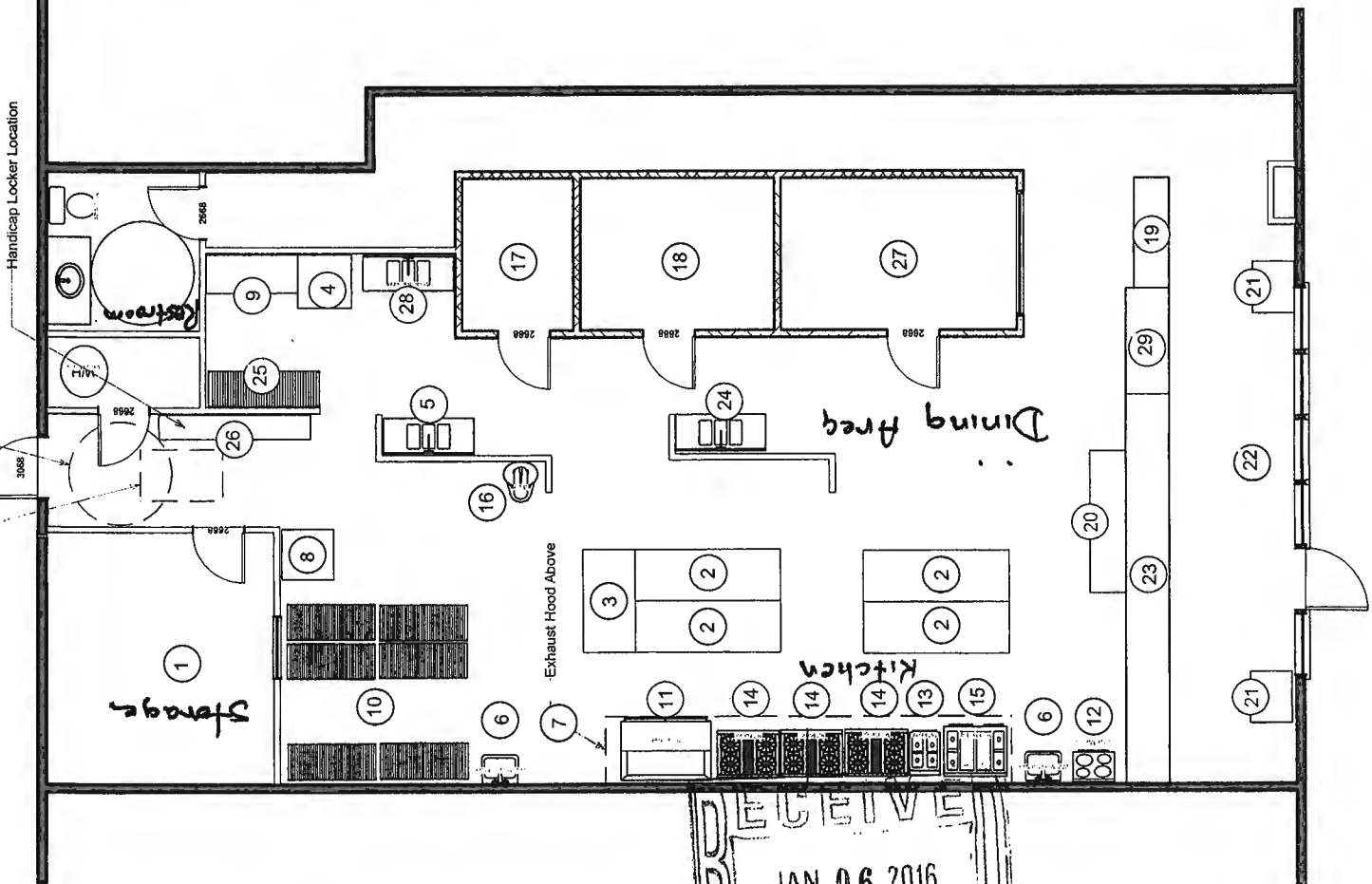

EQUIPMENT AND FURNITURE LIST	
1	Storage Room
2	Prep Table 30" x 72"
3	Bakers Table 30" x 60"
4	Wareforce Dishwasher with 4' x 4' Vent Hood
5	Vegetable Sink
6	Handwash Sink
7	Exhaust Hood
8	Ice Machine
9	Dish Wash Station
10	Full Height Storage Shelving
11	Deck Oven
12	Coffee Station
13	Fryer 15" x 30"
14	French Top Stove
15	Flat Top Stove
16	Mixer Station
17	Walk In Freezer
18	Walk In Cooler
19	Deli Display Case
20	Future Beer Refrigerator
21	2 Top Table 24' x 30"
22	Accessible 3 Top Table - 32" High
23	Servive Counter w / 9 Stools
24	Prep Sink
25	Dish Storage
26	Future Employee Lockers
27	Meat Cooler
28	Dish Wash Sink
29	Check-Out Counter
30	

1,950 sq. ft.

Dr Field Goods Bakery and Butcher Shop Floor Plan

RECEIVED
JAN 06 2016
ALCOHOL & GAMING DIVISION



City of Santa Fe, New Mexico

200 Lincoln Avenue, P.O. Box 909, Santa Fe, N.M. 87504-0909
www.santafenm.gov

Javier M. Gonzales, Mayor

Councilors:

- Peter N. Ives, Mayor Pro Tem, Dist. 2
- Patti J. Bughee, Dist. 1
- Signe I. Lindell, Dist. 1
- Joseph M. Maestas, Dist. 2
- Carmichael A. Dominguez, Dist. 3
- Christopher M. Rivera, Dist. 3
- Ronald S. Trujillo, Dist. 4
- Bill Dimas, Dist. 4

November 05, 2015

Debora Lopez, Department Director
Alcohol & Gaming Division
2550 Cerrillos Rd.
Santa Fe, NM 87505

RE: Zoning Verification 2860 Cerrillos Road.

Dear Ms. Lopez,

This is in response to a request for zoning verification on the above referenced property. According to the Official Zoning Map, Page K-16 updated October 4, 2009; this property zoned C-2 (General Commercial).

"14-4.3(G) C-2 General Commercial District"

For full listing of uses allowed in a C-2 District, reference Chapter 14 "Land Development", Article 14-6 "Permitted Uses and Use Regulations", Table 14-6-1-1 "Table of permitted Uses" (<http://clerkshq.com/default.ashx?clientsite=Santafe-nm>).

The sale of alcohol in conjunction with a "Beer and Wine" license is permitted within the C-2 District.

Note: The information provided in this letter is solely derived from the Official Zoning Map and the minimum requirements set forth in Chapter 14, SFCC 1987. It is the intent of this letter to advise of the ordinances pertaining to the zone districts. It is not the intent to state that the subject property complies with zoning requirements. Occupancy is determined based on zoning compliance at the time of building permit or certificate of occupancy, whichever applies. Additionally, it is not the intent to interfere with or to abrogate or annul any official document including conditions or safeguards made a part of the subject property at the time of any public hearings. Applicants are advised to pursue an independent search of official documents.

If you have any questions, please call me at 505-955-6587.

Daniel A. Esquibel
Land Use Planner Senior

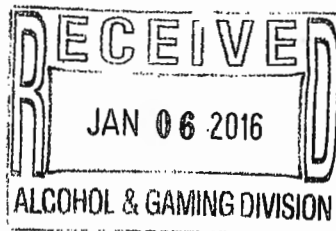



Santa Fe
Christian Fellowship Church

2860 Cerrillos Rd. Santa Fe, New Mexico 87507

January 3, 2016

To Whom it May Concern,

This letter is to state that I, John Maiolo, Pastor of The Santa Fe Christian Fellowship Church together with the congregation have no objections to the Dr. Field Goods Kitchen Bakery and Butcher Shop serving beer or wine.

Should you have any further questions, please feel free to contact me at (505) 470-0234.

Sincerely,

Pastor John S. Maiolo

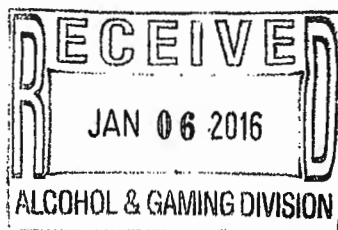

CITY OF SANTA FE

NOTICE OF PUBLIC HEARING

Notice is hereby given that the Governing Body of the City of Santa Fe will hold a public hearing on Wednesday, March 30, 2016 at its regular City Council Meeting, 7:00 p.m. session, at City Hall Council Chambers, 200 Lincoln Avenue.

The purpose of this public hearing is to discuss a request from Paperbag, LLC for the following:

- a) Pursuant to §60-6B-10 NMSA 1978, a request for a waiver of the 300 foot location restriction to allow the sale of beer and wine at Dr. Field Goods Kitchen, Butcher Shop & Bakery, 2860 Cerrillos Road, #B5 which is within 300 feet of Santa Fe Christian Fellowship, 2860 Cerrillos Road, Suite #C5, Santa Fe;
- b) If the waiver of the 300 foot restriction is granted, a request from Paperbag, LLC for a Restaurant Beer & Wine License with on-premise consumption only, to be located at Dr. Field Goods Kitchen, Butcher Shop & Bakery, 2860 Cerrillos Road, #B5, Santa Fe.

All interested citizens are invited to attend this public hearing.

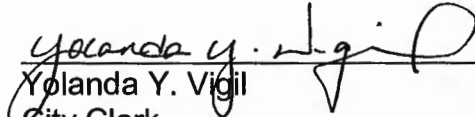
Yolanda Y. Vigil
City Clerk

Received by The New Mexican
Date February 18, 2016
To Be Published February 23, 2016
and March 1, 2016
By [Signature]
The New Mexican (Signature)

City of Santa Fe



PUBLIC WORKS DEPARTMENT
TRAFFIC DIVISION
Post Office Box 909
Santa Fe, NM 87504-0909
Phone: 984-6619 (voice)
984-6627 (fax)

Liquor License Request Supplemental Information

Instructions:

The following information is needed regarding this request. Please type or print clearly.
Complete this form and leave with the City Clerk while picking up the newspaper publication notice.

Thank you.

1. Name of owner of business Sosh Gerwin
Name of business where proposed license is to be used Dr. Field Goods Kitchen
Business street address 2860 Carrillos rd Santa Fe NM 87507
Telephone number 505-471-0093
2. Indicate the type of liquor license this request entails.
 issuance of new license (indicate type: Beer & wine)
 transfer of location of existing license (indicate type: _____)
 transfer of ownership of existing license (location to remain the same)
3. Is this an existing business?
 yes
 no
4. Does the location where this license will be used currently sell liquor?
 yes
 no

5. If the answer to question #3 is yes, indicate the current hours of operation of the business.
Tuesday - Through Saturday 7-7
 If the hours of operation will change due to the sales of liquor, indicate the revised hours.

6. If this is a new business, indicate the anticipated hours of operation of the business.
Tues Through Saturday 7-7
7. If the answer to question #3 is yes, indicate the anticipated change in business volume due to the sales of liquor.
 Business is expected to increase (number of customers per day _____)
 Business is expected to decrease (number of customers per day _____)
 Business is expected to remain the same
8. If the answer to question #3 is no, indicate the number of customers anticipated per day at the business.

9. Estimate the number of customers per day who currently drive (or will drive) to the business versus the number who walk.
10 number of customers who drive
5 number of customers who walk
10. Has liquor ever been sold at this business site?
 yes
 no
11. If the answer to question #10 is yes, indicate the name of the establishment and the year(s) that liquor sales occurred.
 Name _____
 Year(s) _____
12. Indicate which of the following statements best reflects your opinion regarding traffic impacts if this request is approved.
 traffic can be expected to increase on adjacent streets if this request is approved
 traffic will not increase on adjacent streets if this request is approved

Name of person completing this form Sash Gerwin
 Telephone number 505 471-0043
 Date 2/18/06

(For City Use Only)

Based upon the information provided above, staff has the following comments:
 It does not appear that the approval of this request will create any unacceptable traffic impacts.
 It appears that the approval of this request will create unacceptable traffic impacts (see comments below).
 Other comments _____

By [Signature]
 Title TRAFFIC ENGINEER
 Date 2/23/06



City of Santa Fe, New Mexico

200 Lincoln Avenue, P.O. Box 909, Santa Fe, N.M. 87504-0909
www.santafenm.gov

Javier M. Gonzales, Mayor

Councilors:

- Peter N. Ives, Mayor Pro Tem, Dist. 2
- Patti J. Bushee, Dist. 1
- Signe I. Lindell, Dist. 1
- Joseph M. Maestas, Dist. 2
- Carmichael A. Dominguez, Dist. 3
- Christopher M. Rivera, Dist. 3
- Ronald S. Trujillo, Dist. 4
- Bill Dimas, Dist. 4

DATE: February 24, 2016 for the City Council Meeting of March 30, 2016

TO: Mayor and City Council Members

VIA:

 Brian Snyder, City Manager
 Lisa Martinez, Director, Land Use Department *MP Acting Dept Dir.*

FROM: Antoinette Padilla, Code Enforcement Specialist *A.P.*

ITEM AND ISSUE

Litter and noise impact assessment, due to a request from Paperbag, LLC for the following:

- a) Pursuant to §60-6B-10 NMSA 1978, a request for a waiver of the 300 foot location restriction to allow the sale of alcoholic beverages at the Dr. Field Goods Kitchen, Butcher Shop & Bakery, 2860 Cerrillos Road, #B5 which is within 300 feet of the Santa Fe Christian Fellowship Church, 2860 Cerrillos Road, Suite #C5, Santa Fe;
- b) If the waiver of the 300 foot restriction is granted, a request from Paperbag, LLC for a Restaurant Beer & Wine License with on-premise consumption only, to be located at Dr. Field Goods Kitchen, Butcher Shop & Bakery, 2860 Cerrillos Road, #B5, Santa Fe, New Mexico.

BACKGROUND AND SUMMARY

A substantial change in litter and noise due to this request is not anticipated.



2860 Cerrillos Road, #B5



Legend

- City Limits
- Full Address Labels
- Parcels
- Airport Clear Zones
- Santa Fe River
- Zoning**
 - RR Rural Residential
 - R1, (PUD) Single-Family 1du/ac.
 - R2, (DT), (PUD), (AC) Single - Family 2du/ac
 - R3, (PUD) Single - Family 3du/ac
 - R4 Single - Family 4du/ac
 - R5, (DT), (PUD), (AC), R6 Single - Family 5-6du/ac
 - R7, (I), (PUD), R8 Single - Family 7-8du/ac
 - RC5, RCSAC Compound 5du/ac
 - RC8, RCSAC Compound 8du/ac
 - R10, (PUD) Multiple - Family 10du/ac
 - R12, (PUD) Multiple - Family 12du/ac
 - R21, (PUD) Multiple - Family 21du/ac
 - R29, (PUD),(AC) Multiple - Family 29du/ac
 - RAC Residential Arts & Crafts

This map is a user generated static output from an Internet mapping site and is for general reference only. Data layers that appear on this map may or may not be accurate, current, or otherwise reliable. THIS MAP IS NOT TO BE USED FOR NAVIGATION.

60-6B-10. Locations near church or school; restrictions on licensing.

No license shall be issued by the director for the sale of alcoholic beverages at a licensed premises where alcoholic beverages were not sold prior to July 1, 1981 that is within three hundred feet of any church or school. A license may be granted for a proposed licensed premises if the owner or lessee has, prior to establishment of a church or school located within three hundred feet of the proposed licensed premises, applied for, been granted and maintained a valid building permit for the construction or renovation of the proposed licensed premises and has filed on a form prescribed by the director a notice of intention to apply for transfer of a license to the proposed licensed premises. A license may be granted for a proposed licensed premises if a person has obtained a waiver from a local option district governing body for the proposed licensed premises. For the purposes of this section, all measurements taken in order to determine the location of licensed premises in relation to churches or schools shall be the straight line distance from the property line of the licensed premises to the property line of the church or school. This provision shall not apply to any church that has been designated as an historical site by the cultural properties review committee and which does not have a regular congregation.