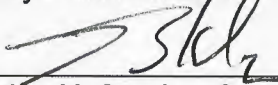

City of Santa Fe, New Mexico

memo

DATE: September 5, 2014

TO: Mayor Gonzales & City Councilors

VIA: 
Brian K. Snyder, City Manager

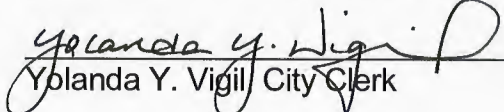
FROM: 
Yolanda Y. Vigil, City Clerk

ITEM & ISSUE

Request from Joe Wade Fine Art for a waiver of the 300 foot location restriction and approval to allow the dispensing/consumption of wine at Joe Wade Fine Art, 102 East Water Street, which is within 300 feet of The Church of Antioch at Santa Fe, 207 Old Santa Fe Trail.

BACKGROUND AND SUMMARY

Pursuant to §60-6B-10 NMSA 1978, Joe Wade Fine Art has requested a waiver of the 300 foot location restriction to allow the dispensing/consumption of wine at Joe Wade Fine Art, 102 East Water Street. This request is for a Gallery Opening event to be held on Friday, September 12, 2014 from 5:00 p.m. to 7:00 p.m.

Attached is a letter of support from Reverend Daniel P. Danganan, The Church of Antioch at Santa Fe.

ACTION REQUESTED

I hereby request that the City Council indicate its decision on the request for a waiver of the 300 foot location restriction and approval to allow the dispensing/consumption of wine at Joe Wade Fine Art, 102 East Water Street for a Gallery Opening event to be held on Friday, September 12, 2014 from 5:00 p.m. to 7:00 p.m.

Attachments: Letter/Joe Wade Fine Art
Letter/The Church of Antioch at Santa Fe
Special Dispenser Permit Application
§60-6B-10 NMSA 1978



JoeWadeFineArt

August 11, 2014

Mayor Javier Gonzales and the Santa Fe City Council
City Council Chambers
200 Lincoln Avenue
Santa Fe, New Mexico 87501

Dear Mayor Javier Gonzales and the Santa Fe City Council,

Joe Wade Fine Art, located at 102 East Water Street in Santa Fe, respectfully requests a waiver for special dispenser permit to serve wine from 5 to 7 pm at the following event:

September 12, 2014 Roger Williams Solo Exhibition

We have garnered written support for this event from Bishop Daniel Dangaran of the Church of Antioch at Santa Fe. Additionally, we have completed the necessary special dispenser application for the above mentioned date with Susan's Fine Wines, and have licensed State of New Mexico alcohol server and a licensed security service (American Security) scheduled for the event.

Thank you for your consideration. If we may answer any questions please do not hesitate to contact us at 505-988-2727.

Respectfully,

Judy I. Wade, Owner
Joe Wade Fine Art

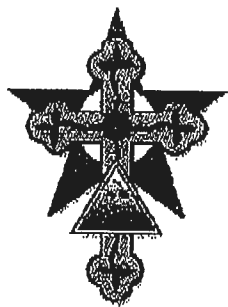

The church of Antioch at Santa Fe

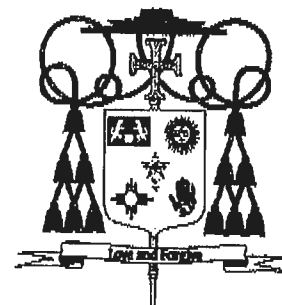

Most Rev. Daniel P. Dangaran, D.Min., Pastor
P.O. BOX 32596 Santa Fe, NM 87594-2596
505 983-9003 +++ antiochsfe1@gmail.com

August 8, 2014

Mayor Javier Gonzales and The Santa Fe City Council
City Council Chambers
200 Lincoln Avenue
Santa Fe, New Mexico

Dear Mayor Gonzales and The Santa Fe City Council:

I am the Pastor and Bishop of the Church of Antioch at Santa Fe,
which holds its Eucharistic

Liturgy (Mass) at the Loretto Chapel on Sundays.

As the Pastor and Bishop, I hereby give my permission and support
to the granting of a dispensation, which would allow the Joe Wade
Fine Art Gallery to serve white wine at their Art Event:

The Church of Antioch at Santa Fe is independent from other Catholic
denominations,
and is in service to ALL

September 12, 2014 Roger Williams Solo Exhibition 5 to 7 pm

Sincerely,

A handwritten signature in black ink that reads "+ Daniel". The plus sign is positioned to the left of the name, and the name is written in a cursive, slightly stylized font.

The Most Rev. Daniel P. Dangaran, D.Min.

Pastor and Bishop

The Church of Antioch at Santa Fe

The Church of Antioch at Santa Fe is independent from other Catholic
denominations,
and is in service to ALL

ALCOHOL & GAMING DIVISION
SPECIAL DISPENSER PERMIT APPLICATION (60-6A-12 NMSA)

Fee Per day: \$50.00 Public Event
 \$25.00 Private Event (Catered) (all fees are non refundable)

A copy of all approved permits will be sent to the Special Investigations Division of the Department of Public Safety. They will notify you directly if they need additional information.

Circle those that apply - All Age Event - Beer Garden - Indoor /Outdoor

LICENSE HOLDER INFORMATION

Business Name (DBA) SUSAN'S FINE WINE + SPIRITS Owner Name SF WINE + SPIRITS INC Local Option District CITY OF SANTA FE
Mailing Address 1005 ST FRANCIS STE 101 City, State & Zip SANTA FE NM 87505
Contact Telephone # 984-1582 Fax # 216-0662 Email Address KICHEL@SFWINEANDSPIRITS.COM Liquor License # 156
Circle those that apply - All Age Event - Beer Garden - Indoor /Outdoor Event Begin Time 5 End Time 7
Wrist Band / Stamps
Description and Name of Event GAUERY OPENING Date(s) of Event 9/12/14 Alcohol Service Begin Time 5 End Time 7
Physical Address of Event and Name of Building or Business JOE WADE FINE ART Number of Persons expected to Drink 75
Description of Security AMERICAN SECURITY Number of Security 1 Security Contact Name EDDIE CANTANA Contact Telephone # 474-21306

SPONSOR INFORMATION

Sponsor of Event JOE WADE FINE ART Contact Name JOE WADE Contact Telephone # 988-7727

BUILDING/PROPERTY OWNER APPROVAL

Name (print) ERIC BARBER Signature  Telephone # 715-1858 Date 8/28/14

LICENSE HOLDER & SERVER CERTIFICATION: I, SF WINE + SPIRITS, INC (Licensee) hereby certify that this event is within the same local option district as the dispenser's license, that event is not within 300 Ft. of a church or school unless alcoholic beverages were sold there prior to July 1, 1981 or a waiver is obtained from the local governing body. I further certify that all persons providing the service of alcoholic beverages are server certified and that they are my employees and that ALL the information in this application is true and correct.

NOTE: List of servers including name, server permit # and server expiration date must be attached to permit application.

Licensee agrees that if any statements or representations herein are found to be false, the director may refuse to issue additional permits.

Licensee Name (print) SF WINE + SPIRITS, INC Signature Suma V. Egan - Agent Date 8.29.14
All profits derived from the sale of liquor will go only to the licensee.

NOTARY INFORMATION

Subscribed and Sworn before me this 29 day of 8, 20 14 Notary Public Michael WANDERSTON Exp. 10/5/16

LOCAL GOVERNING BODY APPROVAL

Print Name _____ Title _____ Date _____ Signature _____ Phone _____ Fax _____

ALCOHOL & GAMING DIVISION USE ONLY

Approved by: _____ Date _____ Permit Number _____

Attachments: 1) Floor plan - (Pictures) _____ 2) Fees per day (listed on top of page) _____ 3) Server information list _____

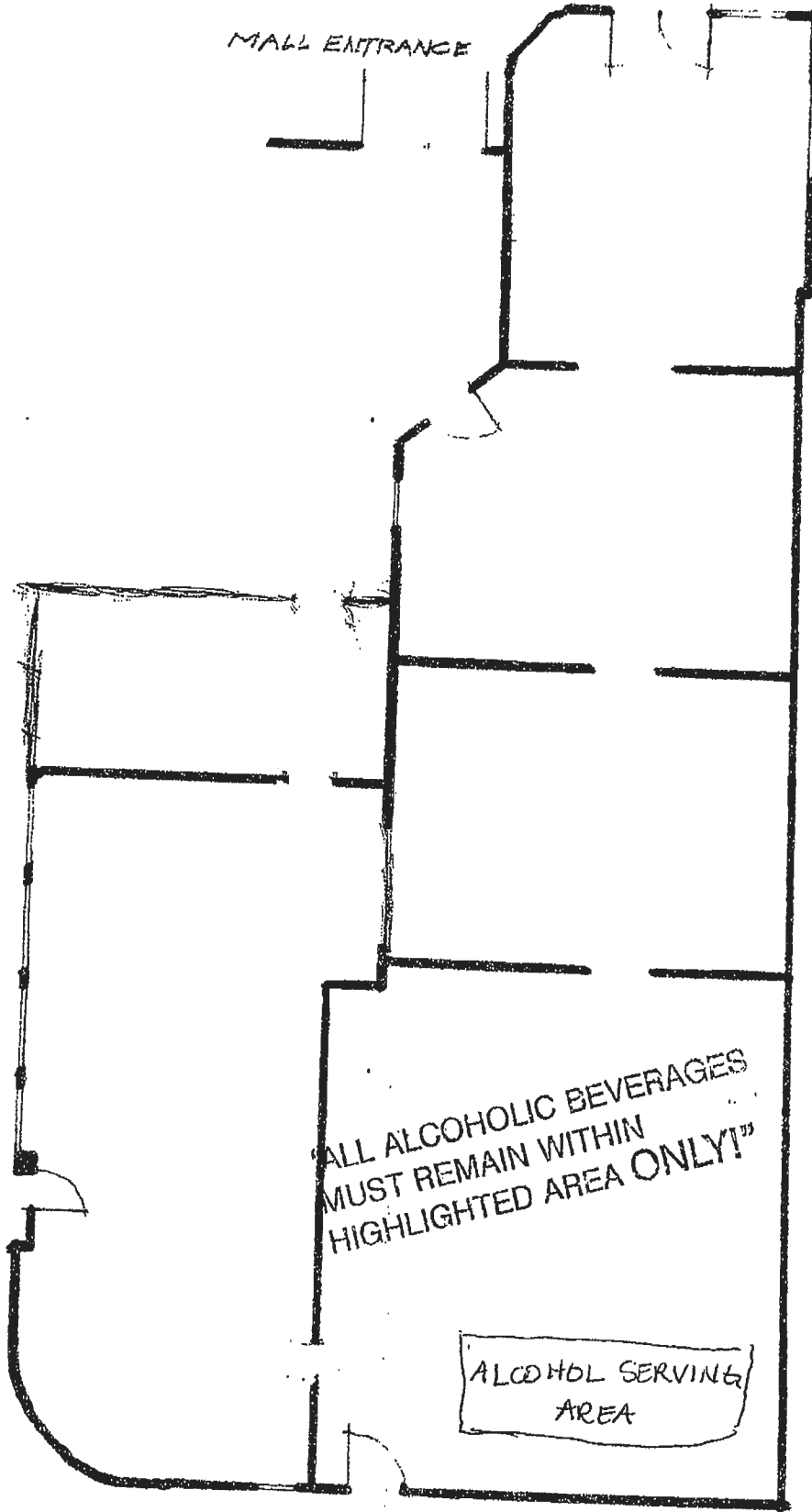

SCHEMATIC FLOOR PLAN FOR JOE WADE FINE ARTS

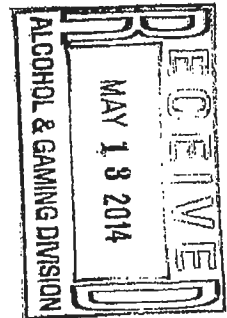

60-6B-10. Locations near church or school; restrictions on licensing.

No license shall be issued by the director for the sale of alcoholic beverages at a licensed premises where alcoholic beverages were not sold prior to July 1, 1981 that is within three hundred feet of any church or school. A license may be granted for a proposed licensed premises if the owner or lessee has, prior to establishment of a church or school located within three hundred feet of the proposed licensed premises, applied for, been granted and maintained a valid building permit for the construction or renovation of the proposed licensed premises and has filed on a form prescribed by the director a notice of intention to apply for transfer of a license to the proposed licensed premises. A license may be granted for a proposed licensed premises if a person has obtained a waiver from a local option district governing body for the proposed licensed premises. For the purposes of this section, all measurements taken in order to determine the location of licensed premises in relation to churches or schools shall be the straight line distance from the property line of the licensed premises to the property line of the church or school. This provision shall not apply to any church that has been designated as an historical site by the cultural properties review committee and which does not have a regular congregation.