



# City of Santa Fe, New Mexico

# memo

DATE: March 20, 2014

TO: Mayor Gonzales & City Councilors

VIA: \_\_\_\_\_  
Brian K. Snyder, City Manager

FROM: Yolanda Y. Vigil  
Yolanda Y. Vigil, City Clerk

## **ITEM & ISSUE**

Request from Santa Fe Preparatory School for a waiver of the 300 foot location restriction and approval to allow the dispensing/consumption of alcoholic beverages at the Santa Fe Preparatory School Gymnasium, 1101 Camino de la Cruz Blanca.

## **BACKGROUND AND SUMMARY**

Pursuant to §60-6B-10 NMSA 1978, a request from Santa Fe Preparatory School for a waiver of the 300 foot location restriction has been submitted to allow the dispensing/consumption of alcoholic beverages at the Santa Fe Preparatory School Gymnasium, 1101 Camino de la Cruz Blanca. The request is for the Santa Fe Prep Parents' Association "Gala 1964" to be held on April 5, 2014 from 6:30 p.m. to 12:00 a.m.

Attached is a letter from Bruce Sachs, Santa Fe Preparatory School Director of Finance, requesting approval of the aforementioned event.

## **ACTION REQUESTED**

I hereby request that the City Council indicate its decision on the request for a waiver of the 300 foot location restriction and approval to allow the dispensing/consumption of alcoholic beverages at the Santa Fe Preparatory School Gymnasium, 1101 Camino de la Cruz Blanca for the Santa Fe Prep Parents' Association "Gala 1964" to be held on April 5, 2014 from 6:30 p.m. to 12:00 a.m.

Attachments: Applicant Letter  
Special Dispenser Application  
§60-6B-10 NMSA 1978



## SANTA FE PREP

Opening a World of Possibilities

March 13, 2014

Mayor Javier Gonzales  
Santa Fe City Council  
200 Lincoln Ave.  
Santa Fe, NM 87501

Dear Mayor Gonzales and City Council Members,

I am writing to request a liquor permit for Santa Fe Prep Parents' Association Gala in support of Breakthrough Santa Fe and tuition assistance. The theme is "Gala 1964" in honor of our 50 years in the Santa Fe community. The date for our event is April 5, 2014 at 6:30 pm. It will take place in our gymnasium and we are expecting around 200 guests. We will have security guards here the entire evening. This event annually raises \$60,000 to \$80,000 for children in our community to attend Prep or Breakthrough Santa Fe. Thank you for your consideration.

Sincerely yours,

Bruce Sachs  
Director of Finance



SPECIAL DISPENSER PERMIT APPLICATION (60-6A-12)

Fee per day:  \$50 Public Celebration  \$25 Private Event (All fees are non-refundable)

LICENSE HOLDER INFORMATION

Business Name (DBA) KELLY LIQUOR BARN. Owner Name STAR INVESTMENT LLC License Number 476  
Street Address: 2885 CERRILLOS RD. City, State, Zip SANTA FE, NM 87507  
Mailing Address Same. City, State, Zip SANTA FE, NM 87507  
Phone # (505) 471-3960 Fax # (505) 471-8199 Local Option District SANTA FE CITY.

EVENT INFORMATION

Description of Event Gala / Auction Fundraiser Date(s) of Event April 5, 2014 Begin Time 6:30 End Time 12:00  
Physical Address of Event Santa Fe Prep Gymnasium Number of Persons expected 200  
Description of Security Liquor Barn Servers Number of Security personnel to be at this function 2  
Security Contact Name Hector Velez Telephone # 471-3960

SPONSOR INFORMATION

Sponsor of Event Santa Fe Prep Parents Association Name Margaret Kennedy Signature [Signature] Phone 505-823-181 Date 3/14/2014  
BUILDING OWNER APPROVAL  
Name (print) Bruce Sachs Signature [Signature] Phone 505-823-181 Date 3/14/2014

LICENSE HOLDER AND SERVER CERTIFICATION

I, YONG LIU (Licensee) hereby certify that this event is within the same local option district as the dispenser's license, that event is not within 500 feet of a church or school unless alcoholic beverages were sold there prior to July 1, 1981 or a waiver is obtained from the local governing body. I further certify that all persons providing the service of alcoholic beverages are server certified and that they are my employees and that ALL the information in this application is true and correct.  
**NOTE: List of servers including name, server permit # and server expiration date must be attached to permit application.**  
Licensee agrees that if any statements or representations herein are found to be false, the director may refuse to issue additional permits.

Licensee Name (print) YONG LIU Signature (Licensee Only) [Signature] Date 3/14/14  
All profits derived from the sale of liquor will go only to the licensee. Only the owner or authorized person under this license may sign the permit.

NOTARY INFORMATION

Subscribed and Sworn before me this 14 day of MARCH, 2014 Notary Public [Signature] Exp. 10-27-14

LOCAL GOVERNING BODY APPROVAL

Print Name \_\_\_\_\_ Title \_\_\_\_\_ Signature \_\_\_\_\_ Date \_\_\_\_\_

*Alcohol and Gaming Division Use Only*

Approved by: \_\_\_\_\_ Date: \_\_\_\_\_ Permit Number: \_\_\_\_\_

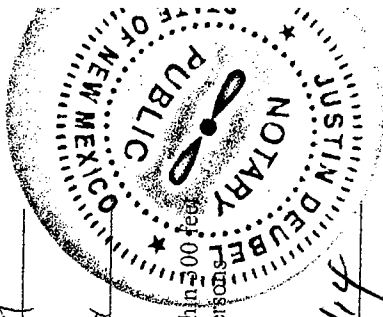

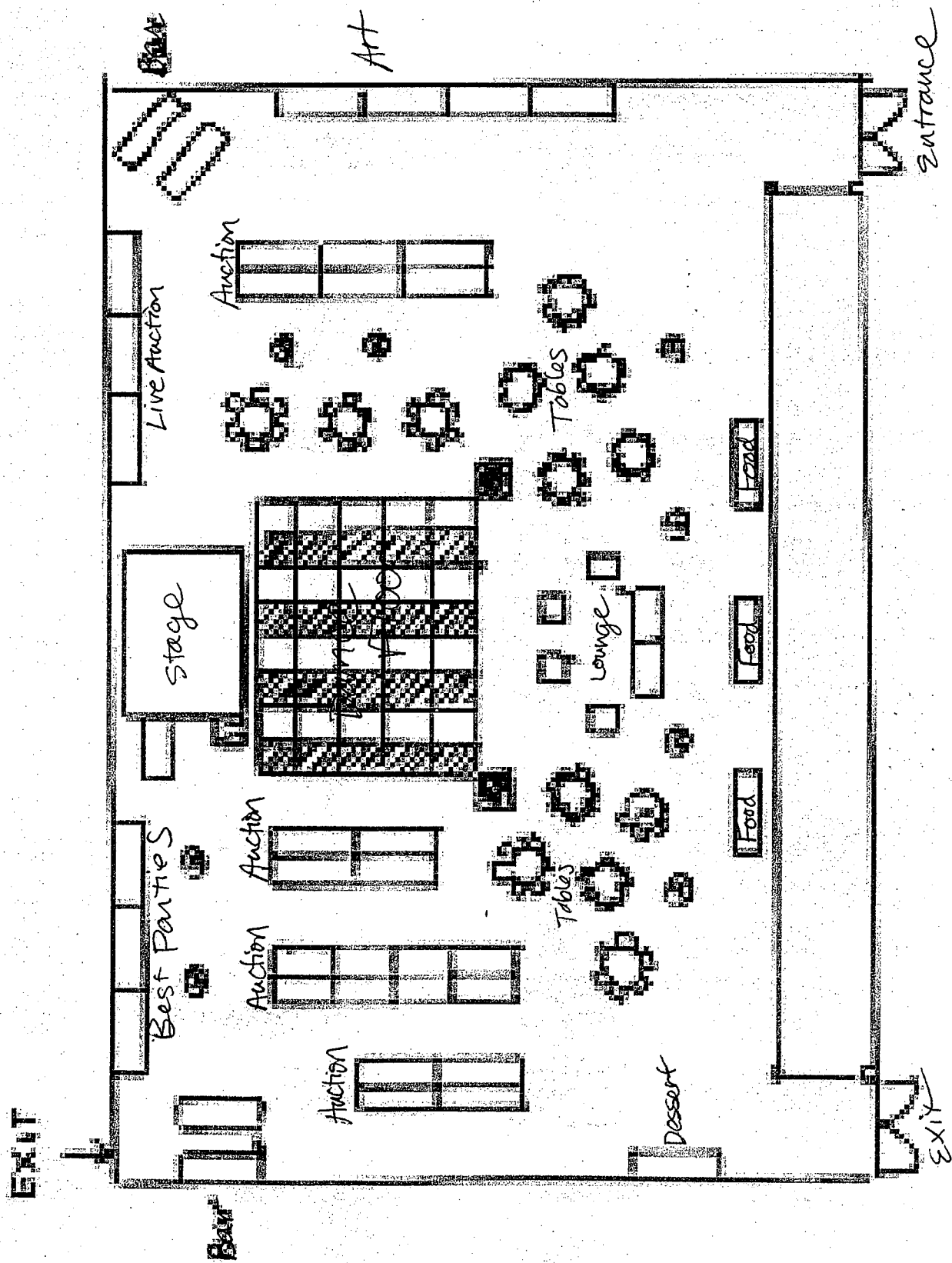

Santa Fe Prep Gymnasium

**60-6B-10. Locations near church or school; restrictions on licensing.**

No license shall be issued by the director for the sale of alcoholic beverages at a licensed premises where alcoholic beverages were not sold prior to July 1, 1981 that is within three hundred feet of any church or school. A license may be granted for a proposed licensed premises if the owner or lessee has, prior to establishment of a church or school located within three hundred feet of the proposed licensed premises, applied for, been granted and maintained a valid building permit for the construction or renovation of the proposed licensed premises and has filed on a form prescribed by the director a notice of intention to apply for transfer of a license to the proposed licensed premises. A license may be granted for a proposed licensed premises if a person has obtained a waiver from a local option district governing body for the proposed licensed premises. For the purposes of this section, all measurements taken in order to determine the location of licensed premises in relation to churches or schools shall be the straight line distance from the property line of the licensed premises to the property line of the church or school. This provision shall not apply to any church that has been designated as an historical site by the cultural properties review committee and which does not have a regular congregation.