

City of Santa Fe, New Mexico

memo

DATE: July 1, 2015

TO: Mayor Gonzales & City Councilors

VIA: 
Brian K. Snyder, City Manager

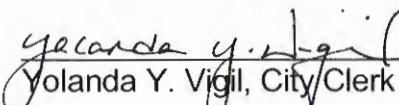
FROM: 
Yolanda Y. Vigil, City Clerk

ITEM & ISSUE

Request from Manitou Galleries for a waiver of the 300 foot location restriction and approval to allow the dispensing/consumption of beer and wine at Manitou Galleries, 225 Canyon Road, which is within 300 feet of the Cathedral Basilica of St. Francis of Assisi, 131 Cathedral Place and the New Mexico School for the Arts, 275 East Alameda Street.

BACKGROUND AND SUMMARY

Pursuant to §60-6B-10 NMSA 1978, Manitou Galleries has requested a waiver of the 300 foot location restriction to allow the dispensing/consumption of beer and wine at Manitou Galleries, 225 Canyon Road for Art Openings on the following dates from 5:00 p.m. to 7:30 p.m.:

- Friday, July 24, 2015
- Thursday, August 20, 2015

Attached are letters of support from Reverend Adam Lee Ortega y Ortiz of the Cathedral Basilica of St. Francis of Assisi and Cindy Montoya, Head of School of the New Mexico School for the Arts.

ACTION REQUESTED

I hereby request that the City Council indicate its decision on the request for a waiver of the 300 foot location restriction and approval to allow the dispensing/consumption of beer and wine at Manitou Galleries, 225 Canyon Road for the aforementioned events.

Attachments: Letter/Manitou Galleries
Letter/The Cathedral Basilica of St. Francis of Assisi
Letter/New Mexico School for the Arts
Special Dispenser Permit Application
§60-6B-10 NMSA 1978

MANITOU GALLERIES

July 1, 2015

Dear Mayor Javier Gonzales and Santa Fe City Council,

Manitou Galleries is requesting permission for a waiver of the 300-foot restriction to allow the dispensing and consumption of wine and beer for the following dates at 225 Canyon Road, Santa Fe, NM 87501:

July 24th, 2015 (from 5pm – 7:30pm)

August 20th, 2015 (from 5pm – 7:30pm)

Kindest regards,



Suzanne Wright
Associate Director
Manitou Galleries
123 W Palace Ave.
Santa Fe, NM 87501
505-986-0440



The Cathedral Basilica of St. Francis of Assisi

P.O. Box 2127, Santa Fe, NM 87504-2127



www.cbsfa.org

RECEIVED
5-19-15

May 14, 2015

Re: Manitou Galleries
225 Canyon Road
Santa Fe, NM 87501

Dear Mayor Gonzales and City Councilors,

Our neighbor, Manitou Galleries, at 225 Canyon Road has asked our permission to process a picnic license on their behalf for three (3) art exhibition opening receptions during the 2015 season on the following dates: Friday, June 26, 2015, July 24, 2015 & August 20, 2015. These events will be held at their gallery from 5:00 p.m. until 7:30 p.m. Catering and licensed security will be arranged by Hector Veleta of Kelly Liquor Barn.

We are fine with these three (3) events going forward and have no objection to the alcoholic beverage service for these events.

Kind Regards,

Very Rev. Adam Lee Ortega y Ortiz
Rector





NEW MEXICO SCHOOL FOR THE ARTS Charter School & Art Institute

Mayor Javier Gonzales
Santa Fe City Council
200 Lincoln Avenue
PO Box 909
Santa Fe, NM 87504-0909

RECEIVED
3-25-15

March 17, 2015

Dear Mayor Gonzales and Santa Fe City Council,

This letter is to grant permission to Manitou Galleries, located at 225 Canyon Road, for a waiver of the 300-foot restriction to allow the dispensing and consumption of wine and beer at their gallery for the following event dates from 5pm to 7:30pm:

Friday, June 26, 2015
Friday, July 24, 2015
Thursday, August 20, 2015

Sincerely,

Cindy Montoya
Cindy Montoya, Head of School
New Mexico School for the Arts
275 East Alameda
Santa Fe, NM 87501

Cc: Frank Rose, Manitou Galleries

**ALCOHOL & GAMING DIVISION
SPECIAL DISPENSER PERMIT APPLICATION (60-6A-12 NMSA)**

Fee Per day: \$50.00 Public Event
 \$25.00 Private Event (Catered) (all fees are non refundable)
 A copy of all approved permits will be sent to the Special Investigations Division of the Department of Public Safety. They will notify you directly if they need additional information.

LICENSE HOLDER INFORMATION

Business Name (DBA) Kelly Liquor Barn Owner Name STAR INVESTMENT LLC Local Option District SANTA FE CITY
 Mailing Address 2885 CARRILLO'S RD City, State & Zip SANTA FE, NM 87127
 Contact Telephone # 471-2199 Fax # 471-2199 Email Address LAGUARD-BARAN@WESTOFFICE.NET
Circle those that apply - All Age Event - Beer Garden - Outdoor/Indoor Event Begin Time 5PM End Time 8:30PM
Wrist Band / Stamps
 Description and Name of Event MANITOU GALLERIES ART OPENING Date(s) of Event 7/24/15 Alcohol Service Begin Time 5PM End Time 7:30PM
 Physical Address of Event and Name of Building or Business MANITOU GALLERIES, 225 CANYON RD, SANTA FE, NM Number of Persons expected to Drink 100
 Description of Security KELLY LIQUOR BARN SECURITY Number of Security 2 Security Contact Name HECOUR VELETA Contact Telephone # 505 471 3960

SPONSOR INFORMATION

Sponsor of Event MANITOU GALLERIES Contact Name SUZANNE WRIGHT Contact Telephone # 505 986 0440

BUILDING/PROPERTY OWNER APPROVAL

Name (print) Cindy Schrock Signature Cindy Schrock Telephone # 996-8696 Date 6-18-15

LICENSE HOLDER & SERVER CERTIFICATION: I, YONG IL JO (Licensee) hereby certify that this event is within the same local option district as the dispenser's license, that event is not within 300 Ft. of a church or school unless alcoholic beverages were sold there prior to July 1, 1981 or a waiver is obtained from the local governing body. I further certify that all persons providing the service of alcoholic beverages are server certified and that they are my employees and that ALL the information in this application is true and correct.

NOTE: List of servers including name, server permit # and server expiration date must be attached to permit application.

Licensee agrees that if any statements or representations herein are found to be false, the director may refuse to issue additional permits.

Licensee Name (print) YONG IL JO Signature [Signature] Date 6/17/15
 Only the owner or authorized person under this license may sign the permit.
NOTARY INFORMATION

Subscribed and Sworn before me this 17 day of June, 20 15 Notary Public Edwin C. [Signature] Exp. 4/30/2016

LOCAL GOVERNING BODY APPROVAL

Print Name _____ Title _____ Date _____ Signature _____ Phone _____
 Date _____ Permit Number _____

ALCOHOL & GAMING DIVISION USE ONLY

Approved by: _____ Date _____
 Attachments: 1) Floor plan - (Pictures) _____ 2) Fees per day (listed on top of page) _____ 3) Server information list _____



MANITON GAUZEY
265 CANYON RD.
SUITE #11
SANTA FE, NM. 87501

RECEIVED
NOV 09 2011

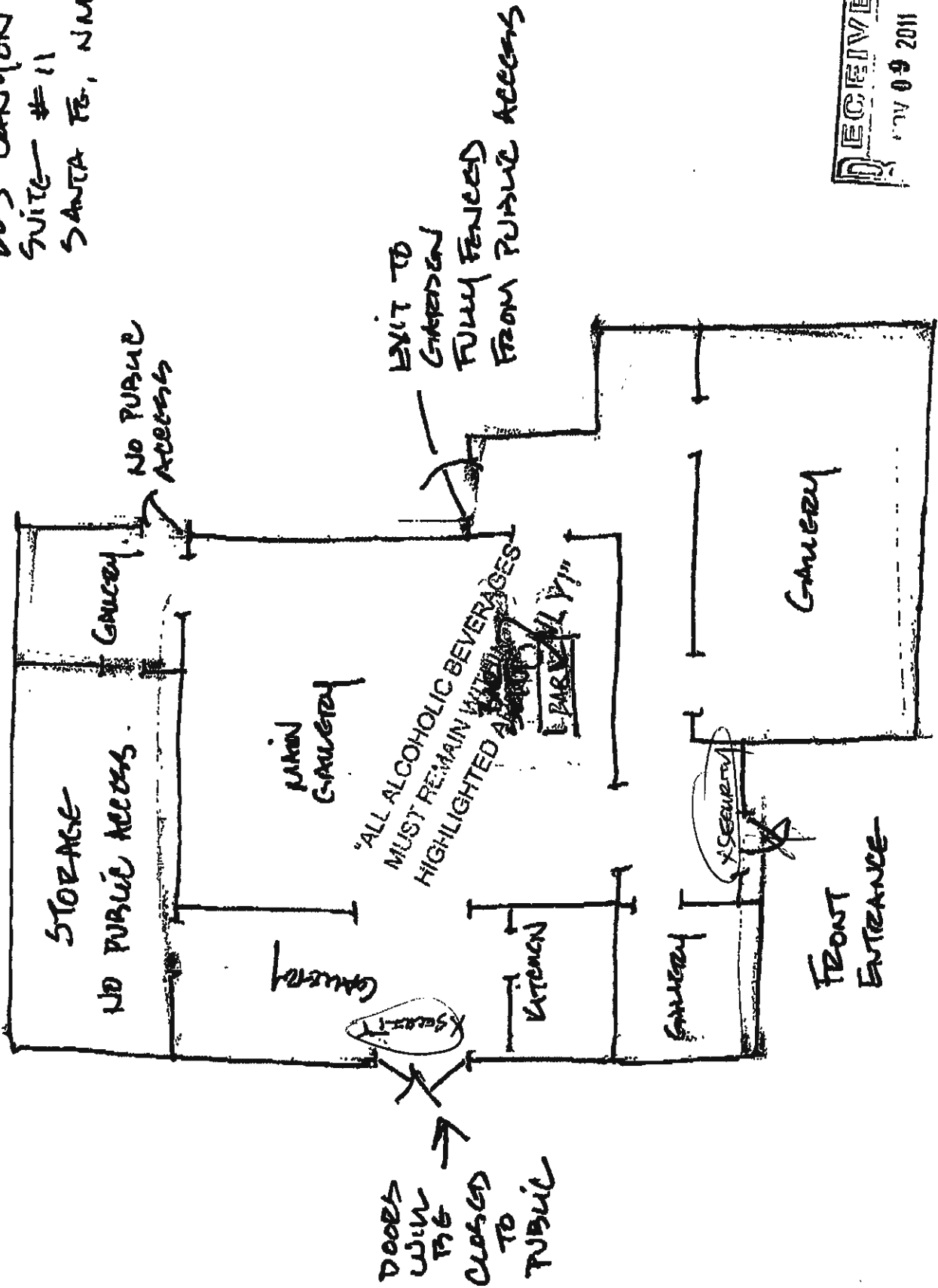

(A)

**ALCOHOL & GAMING DIVISION
SPECIAL DISPENSER PERMIT APPLICATION (60-6A-12 NMSA)**

Fee Per day: \$50.00 Public Event

\$25.00 Private Event (Catered) (all fees are non refundable)

A copy of all approved permits will be sent to the Special Investigations Division of the Department of Public Safety. They will notify you directly if they need additional information.

LICENSE HOLDER INFORMATION

Business Name (DBA) Kelly / LIQUOR BARN Owner Name STAR INVESTMENT LLC Local Option District SANTA FE CITY
 Mailing Address 885 CERRILLOS RD City, State & Zip SANTA FE, N.M. 87507 Liquor License # 476
 Contact Telephone # 471-3910 Fax # 471-8194 Email Address LIQUOR.BARN@QUESTOFFICE.NET
 Circle those that apply - Outdoor Wrist Band / Stamps Event Begin Time 5 PM End Time 8:30 PM
 Description and Name of Event MANITOU GALLERIES ART OPENING Date(s) of Event 8/20/15 Alcohol Service Begin Time 5 PM End Time 7:30 PM
 Physical Address of Event and Name of Building or Business MANITOU GALLERIES, 725 CAMPION RD Number of Persons expected to Drink 100
 Description of Security KELLY LIQUOR BARN SECURITY Number of Security 2 Security Contact Name Hector Velazquez Contact Telephone # 505 471 3740

SPONSOR INFORMATION

Sponsor of Event MANITOU GALLERIES Contact Name SUZANNE WRIGHT Contact Telephone # 505 986 0440

BUILDING/PROPERTY OWNER APPROVAL

Name (print) Cindy Schroeder Signature Cindy Schroeder Telephone # 988-8196 Date 6/19/15

LICENSE HOLDER & SERVER CERTIFICATION: I, YONG IL JO (Licensee) hereby certify that this event is within the same local option district as the dispenser's license, that event is not within 300 Ft. of a church or school unless alcoholic beverages were sold there prior to July 1, 1981 or a waiver is obtained from the local governing body. I further certify that all persons providing the service of alcoholic beverages are server certified and that they are my employees and that ALL the information in this application is true and correct.

NOTE: List of servers including name, server permit # and server expiration date must be attached to permit application.

Licensee agrees that if any statements or representations herein are found to be false, the director may refuse to issue additional permits.

Licensee Name (print) YONG IL JO Signature [Signature] Date 6/17/15
 All profits derived from the sale of liquor will go only to the licensee. Only the owner or authorized person under this license may sign the permit.

NOTARY INFORMATION

Subscribed and Sworn before me this 17 day of June, 20 15 Notary Public Edwin Crawford Date 6/17/15

LOCAL GOVERNING BODY APPROVAL

Print Name _____ Title _____ Date _____ Signature _____ Phone _____

ALCOHOL & GAMING DIVISION USE ONLY

Approved by: _____ Date _____

Attachments: 1) Floor plan - (Pictures)

2) Fees per day (listed on top of page)

Permit Number _____

3) Server information list _____

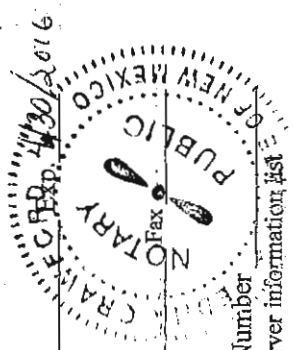

MANJON GAUERY
 125 CANYON RD.
 SUITE #11
 SANTA FE, NM. 87501

RECEIVED
 MAY 09 2011

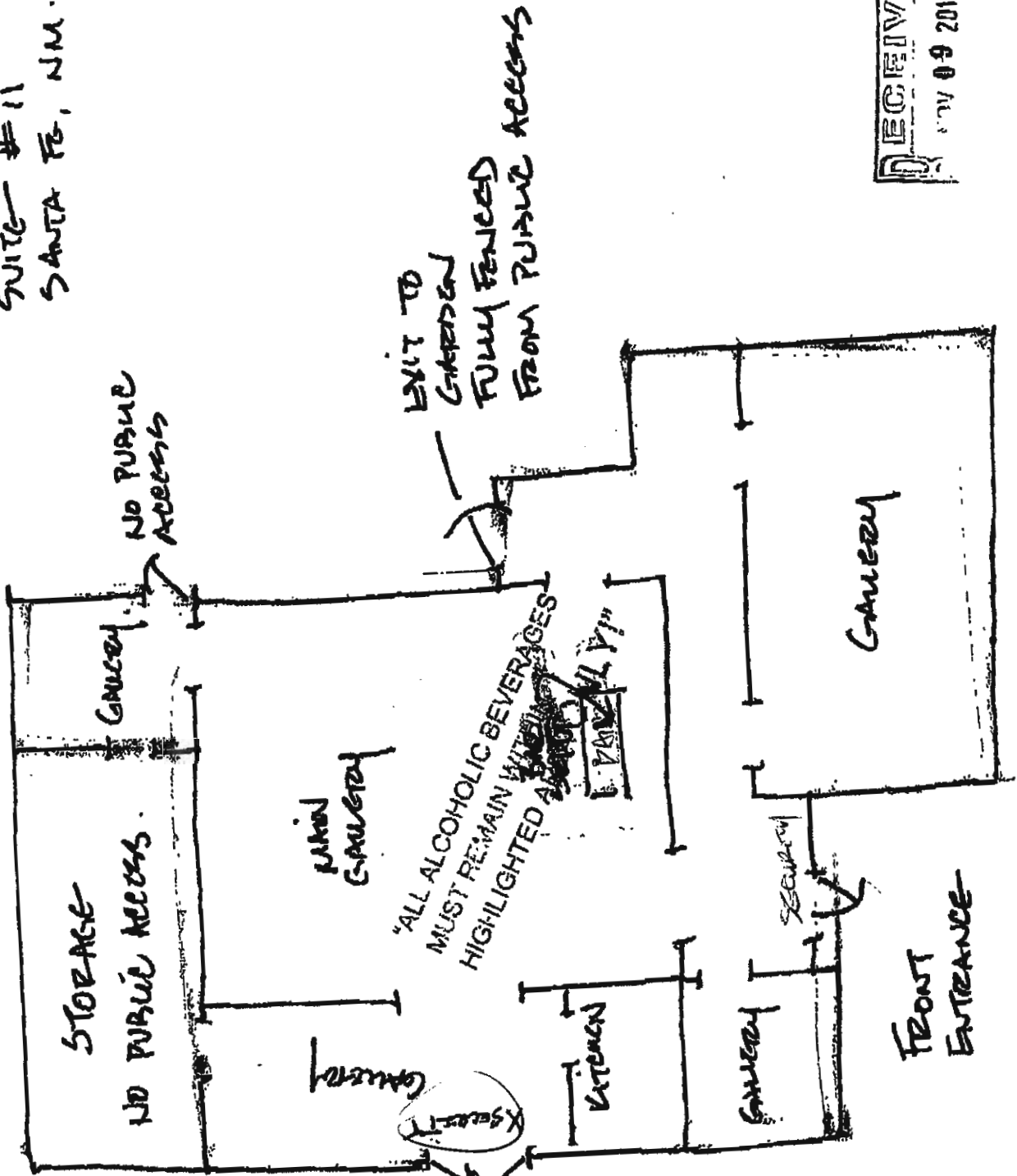

DOORS WITH PIG CLOSED TO PUBLIC

8

60-6B-10. Locations near church or school; restrictions on licensing.

No license shall be issued by the director for the sale of alcoholic beverages at a licensed premises where alcoholic beverages were not sold prior to July 1, 1981 that is within three hundred feet of any church or school. A license may be granted for a proposed licensed premises if the owner or lessee has, prior to establishment of a church or school located within three hundred feet of the proposed licensed premises, applied for, been granted and maintained a valid building permit for the construction or renovation of the proposed licensed premises and has filed on a form prescribed by the director a notice of intention to apply for transfer of a license to the proposed licensed premises. A license may be granted for a proposed licensed premises if a person has obtained a waiver from a local option district governing body for the proposed licensed premises. For the purposes of this section, all measurements taken in order to determine the location of licensed premises in relation to churches or schools shall be the straight line distance from the property line of the licensed premises to the property line of the church or school. This provision shall not apply to any church that has been designated as an historical site by the cultural properties review committee and which does not have a regular congregation.