

1 CITY OF SANTA FE, NEW MEXICO

2 RESOLUTION NO. 2007-13

3 INTRODUCED BY:

4  
5  
6  
7  
8  
9  
10 A RESOLUTION

11 AMENDING THE GENERAL PLAN DESIGNATION FOR A PARCEL GENERALLY  
12 LOCATED EAST OF OLD LAS VEGAS HIGHWAY AND SOUTH OF OLD PECOS  
13 TRAIL COMPRISING AN AREA 15.35 ACRES MORE OR LESS LOCATED WITHIN  
14 THE SEBASTION DE VARGAS GRANT AND LYING WITHIN SECTION 7, T.16N.,  
15 R.10E., N.M.P.M., SANTA FE COUNTY, NEW MEXICO (“HOMEWISE OLD LAS  
16 VEGAS HIGHWAY” GENERAL PLAN AMENDMENT CASE NO. M 2006-52)

17  
18  
19 WHEREAS, the agent for the owner of the subject property has submitted an application  
20 to amend the General Plan Future Land Use Map designation of the property from  
21 “Mountain/Corridor” to “Residential, Very Low Density (1-3 dwelling units per acre)”; and

22 WHEREAS, pursuant to Section 3-19-9 NMSA 1978, the General Plan may be  
23 amended, extended or supplemented; and

24 WHEREAS, the general plan amendment criteria set forth in Section 14-3.2(D) SFCC  
25 2001, have been met; and



# Future Land Use Map

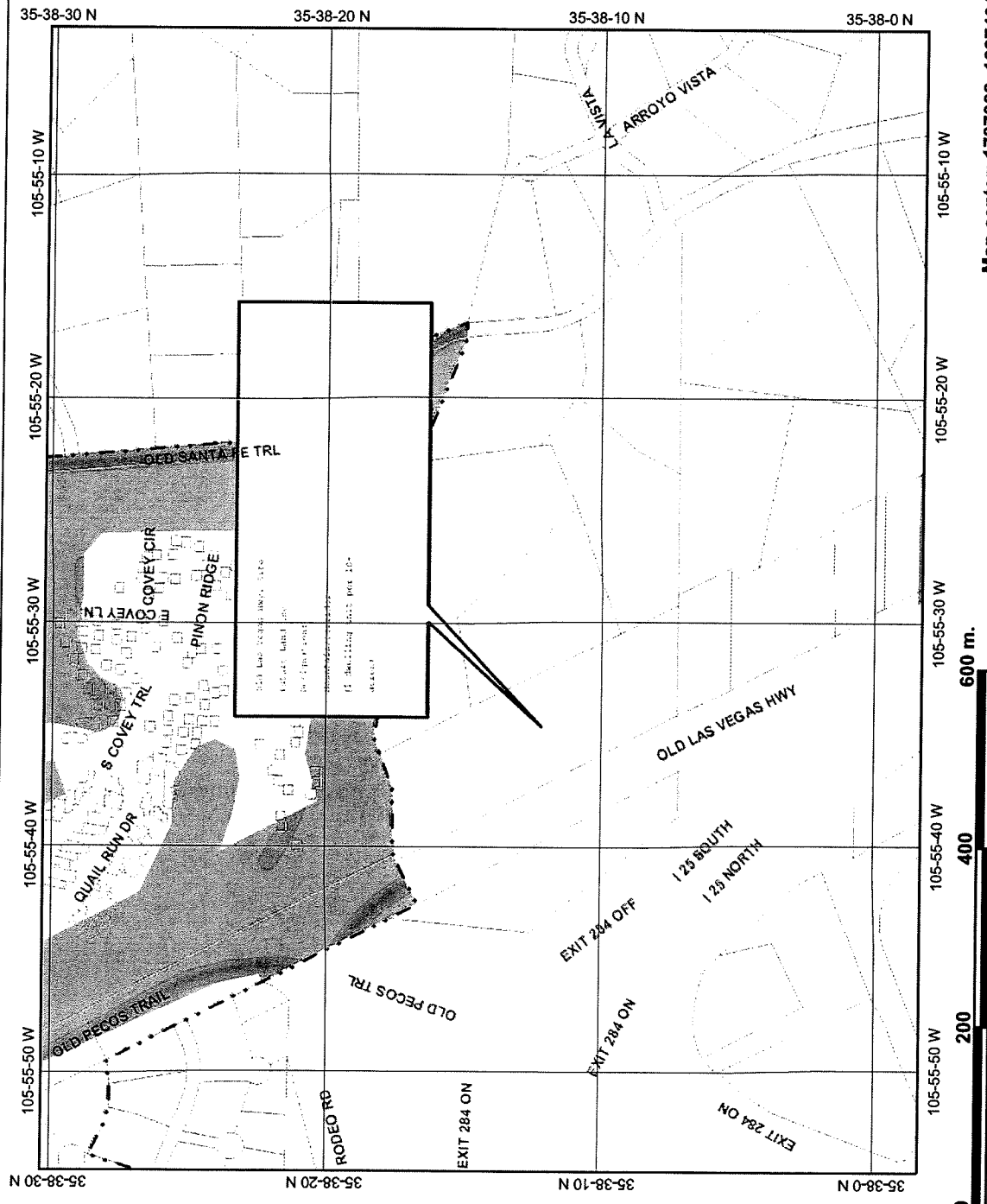

Map center: 1737068, 1687404



This map is a user generated static output from an internet mapping site and is for general reference only. Data layers that appear on this map may or may not be accurate, current, or otherwise reliable. THIS MAP IS NOT TO BE USED FOR NAVIGATION.

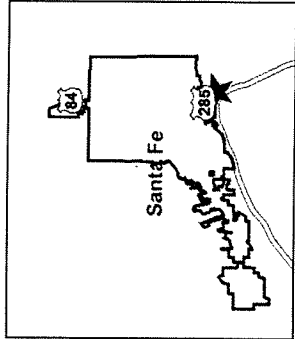

## Legend

- City Limits
- Parcels
- Future Land Use
  - Mountain/Corridor (1 dwelling per 10+ acres)
  - Very Low Density (1-3 dwellings per acre)
  - Low Density (3-7 dwellings per acre)
  - Moderate Density (7-9 dwellings per acre)
  - Medium Density (7-12 dwellings per acre)
  - High Density (12-25 dwellings per acre)
- Regional Commercial
- Community Commercial
- Neighborhood Center
- Transitional Mixed Use
- Business Park
- Office
- Industrial
- Public/Institutional
- Open Space
- Parks
- Greater Agua Fria Area
- Agua Fria Traditional Historic Community
- Major Roads and Highways
- Other Roads and Streets
- Santa Fe River



Scale: 1:6,907

EXHIBIT A